

BEARING REPLACEMENT ON APOLLO SAW.

1. Make sure saw is electrically isolated
2. Remove saw blade and unhook stroke limit chord
3. Stack some 2 X 4 blocks on the saw bench so they are just under the height of the saw motor then lower the motor on to the blocks, this will take the weight off the bearings

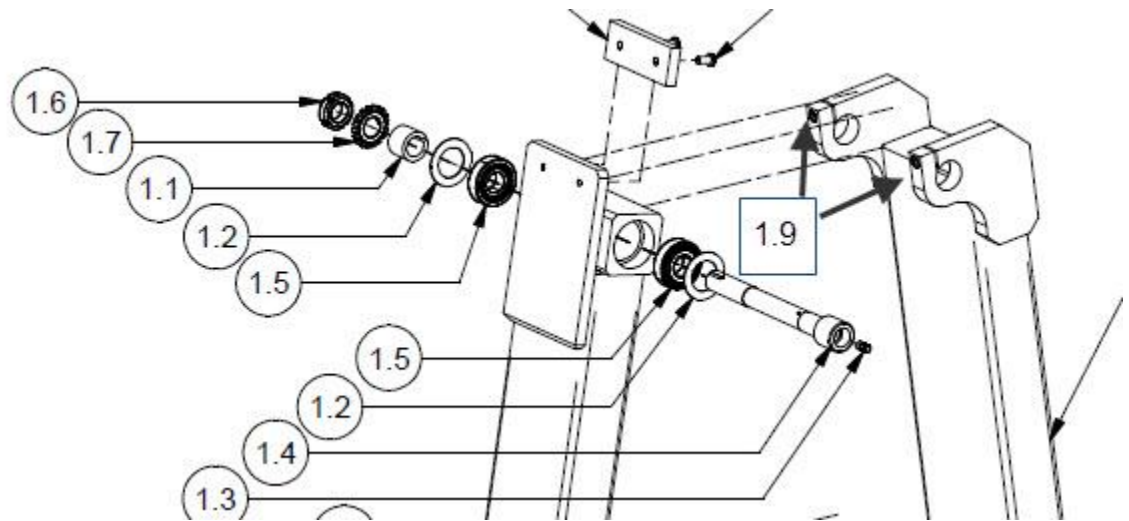

4. Fold the retaining tab up on w-03 washer (1.7) and remove n-3 locknut (1.6)
5. Loosen the retaining bolts (1.9) then using a punch carefully punch the bearing pin (1.4) out of the bearings.
6. Remove old bearings, grease retaining washers and collar, clean out all residual grease and inspect old bearing races. If the bearing races are damaged they will need to be removed, from the opposite end using a long punch tap the race out moving around the race so it comes out evenly.
7. Clean out bearing housing with emery paper making sure to remove all residues when finished.
8. Using a soft face hammer or brass punch insert new bearing races.
9. Inspect old bearing pin for damages, replace if required.
10. Insert pin, washers, bearings, collar, w-03 washer and nut as shown in picture.
11. Tighten nut down until firm and all components are pulled up then back the nut off one notch on the w-03 washer and fold the tab over to retain nut position.
12. Tighten retaining bolts (1.9).
13. Fill the bearing assembly with grease